



# UNIK 5000

## Pressure sensing platform

### Features:

- Ranges from 70mbar (1psi) to 700 bar (10000 psi)
- Accuracy to  $\pm 0.04\%$  Full Scale (FS) Best Straight Line (BSL)
- Stainless steel construction
- Frequency response to 3.5kHz
- High over pressure capability
- Hazardous area certifications
- mV, mA, voltage and configurable voltage outputs
- Multiple electrical and pressure connector options
- Operating temperature ranges from  $-55$  to  $+125^{\circ}\text{C}$  ( $-67$  to  $+257^{\circ}\text{F}$ )
- Online configuration tool



## Specifications

### Gauge ranges

Any zero based range 70 mbar to 70 bar

### Sealed gauge ranges

Any zero based range 10 to 700 bar

### Absolute ranges

Any zero based range 100 mbar to 700 bar

### Differential ranges

Wet/Dry Uni-directional or bi-directional 70 mbar to 35 bar

Wet/Wet Uni-directional or bi-directional 350 mbar to 35 bar

Line pressure 70 bar max

### Barometric ranges

Barometric ranges are available with a min span of 350 mbar

### Customisation

Pressure range and units

Pressure reference

Cable lengths and units

Output options

### Wetted materials

Stainless steel above 70 bar (Stainless steel and Hastelloy below 70 bar spec)

5000 hours hydrogen compatible above 70 bar

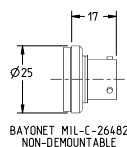
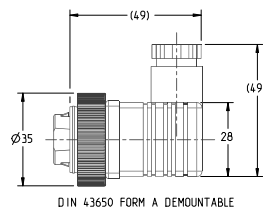
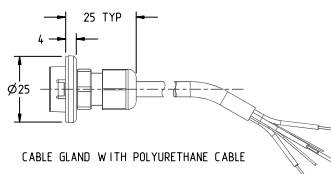
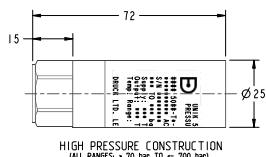
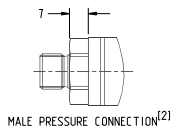

## Full hydrogen compatible version coming soon

For more information scan the QR code

